

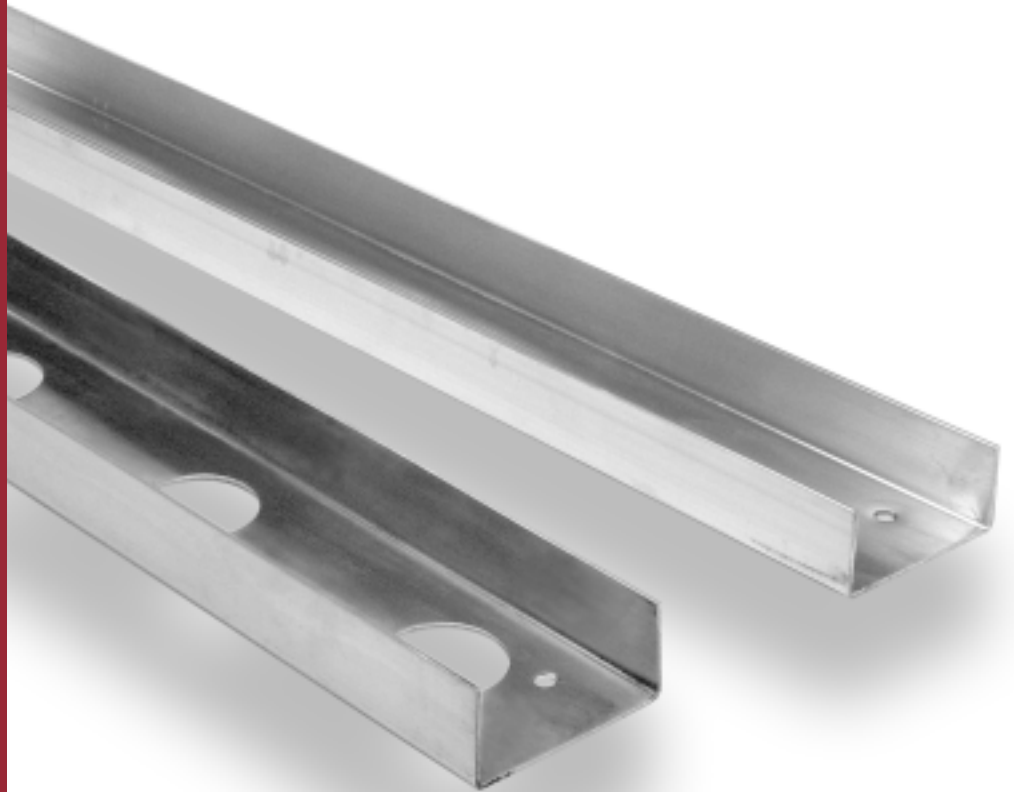

COPECHANNEL

6



**Cable Tray for Branch Power Circuits,
Control, Signal & Tubing Systems.**

COPE CHANNEL

Cope Channel supports single branches of power or multiconductor control cable or instrument tubing. Ideal for communication, fire alarm, or call station and clock cabling. A complete line of devices are available for interfacing with Cope Ladders and Cope Trofs. Compatible with any cable tray system. Cope Channel is more economical than conduit.

Cope Channel is offered in both aluminum and steel, either hot dip mill galvanized (ASTM A 525), or hot dip galvanized after fabrication (ASTM A 386). Covers are available in aluminum and mill galvanized steel. Connectors are furnished with all straight sections and fittings. Other accessories must be ordered separately.

Cope Channel is offered ventilated or solid. Basic units are 3", 4", or 6" wide and are 1 3/4" high. Standard lengths are 12' (3.7m) and 24' (7.4m) long. A load chart is furnished to give you guidance on how often you should support the system. Fitting radii available are 12", 24", and 36". Cope Channel meets NEMA VE-1 standards for cable tray.

ORDERING

For ordering, specify by catalog number using the following prefix to specify the material and finish.

Catalog Number Prefix

	Straight Sections	Fittings, Accessories & Connectors	Covers
Aluminum	1124	24	FS24
Mill-Galv. Steel	6122	22	FS22
Hot-Dip Galv. Steel	6123	23	—

Straight Section and Flanged Cover

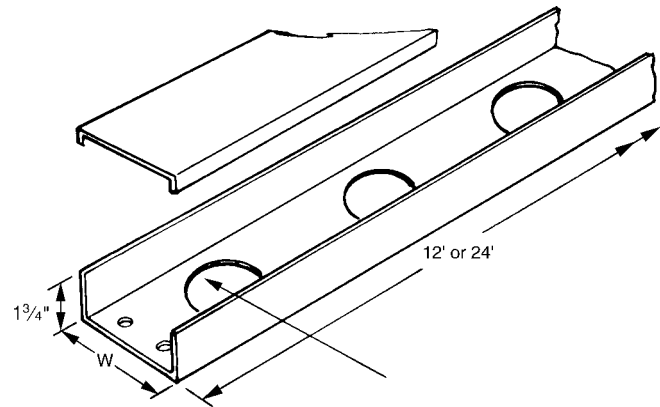

Catalog Number – Straight Section

Finish	Width	Length	Type
1124 - Alum.	3" (76mm)	SL-12 = 12' (3.65m)	V - Vented
6122 - Mill Galv.	4" (102mm)	SL-24 = 24' (7.3m)	S - Solid
6123 - HDGAF	6" (152mm)		

Example: 1124-04SL-12-V is a 4" wide, vented, 12' aluminum tray.

Catalog Number – Flanged Cover

Finish	Width	Length
FS24 - Alum.	3" (76mm)	SL-12 = 12' (3.65m)
FS22 - Mill Galv.	4" (102mm)	
	6" (152mm)	

Example: FS24-04SL-12 is a 4" wide, 12' aluminum cover.

NOTE: 24' length not available.

Loads and Deflection

Width	Cope Channel Basic No.	8' Span (2.4m)		10' Span (3.0m)		12' Span (3.7m)	
		#/Lin Ft*	Deflection	#/Lin Ft*	Deflection	#/Lin Ft*	Deflection
Aluminum-Plain Finish							
3" (76mm)	1124-03SL	8	.21" (5.3mm)	5	.33" (8.4mm)	3	.40" (10.6mm)
4" (102mm)	1124-04SL	13	.34" (8.6mm)	9	.57" (14.5mm)	6	.79" (20.2mm)
6" (152mm)	1124-06SL	15	.37" (9.4mm)	10	.61" (15.5mm)	6	.76" (19.3mm)
Hot Dip Mill-Galvanized Steel (ASTM A-525)							
3" (76mm)	6122-03SL	8	.13" (3.3mm)	5	.20" (5.1mm)	3	.25" (6.4mm)
4" (102mm)	6122-04SL	13	.21" (5.3mm)	9	.35" (8.9mm)	6	.48" (12.2mm)
6" (152mm)	6122-06SL	15	.23" (5.8mm)	10	.37" (9.4mm)	6	.46" (11.7mm)
Hot Dip Galvanized Steel (ASTM A-386), Covers Mill-Galvanized Only							
3" (76mm)	6123-03SL	8	.13" (3.3mm)	5	.20" (5.1mm)	3	.25" (6.4mm)
4" (102mm)	6123-04SL	13	.21" (5.3mm)	9	.35" (8.9mm)	6	.48" (12.2mm)
6" (152mm)	6123-06SL	15	.23" (5.8mm)	10	.37" (9.4mm)	6	.46" (11.7mm)

(*) For kg/m multiply #/Lin Ft by 1.48

90° HORIZONTAL ELBOW

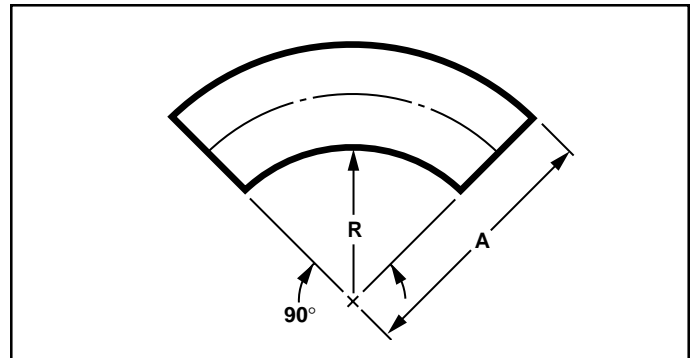
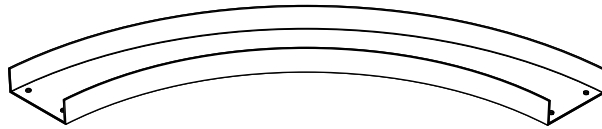

Radius - R	Width - W	Catalog No.	"A" Dim.
12" (305mm)	3" (76mm)	Prefix-039F-12	15" (381mm)
	4" (102mm)	Prefix-049F-12	16" (406mm)
	6" (152mm)	Prefix-069F-12	18" (457mm)
24" (610mm)	3" (76mm)	Prefix-039F-24	17" (432mm)
	4" (102mm)	Prefix-049F-24	28" (711mm)
	6" (152mm)	Prefix-069F-24	30" (762mm)
36" (914mm)	3" (76mm)	Prefix-039F-36	39" (991mm)
	4" (102mm)	Prefix-049F-36	40" (1016mm)
	6" (152mm)	Prefix-069F-36	42" (1067mm)

Prefixes: 22 = Mill-Galv. Steel 23 = Hot-Dip Galv. Steel 24 = Aluminum

60° HORIZONTAL ELBOW

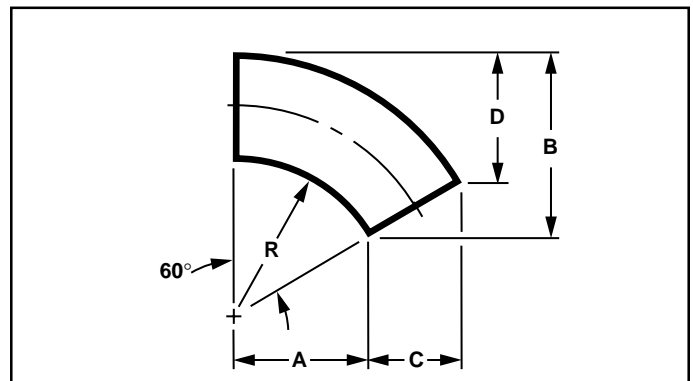
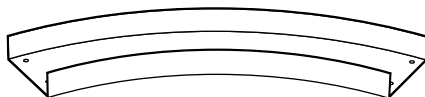

Radius-R	Width - W	Catalog No.	"A" Dim.	"B" Dim.	"C" Dim.	"D" Dim.
12" (305mm)	3" (76mm)	Prefix-036F-12	10 ³ / ₈ " (264mm)	9" (229mm)	2 ⁵ / ₈ " (66mm)	7 ¹ / ₂ " (191mm)
	4" (102mm)	Prefix-046F-12	10 ³ / ₈ " (264mm)	10" (254mm)	3 ¹ / ₂ " (887mm)	8" (203mm)
	6" (152mm)	Prefix-066F-12	10 ³ / ₈ " (264mm)	12" (305mm)	5 ¹ / ₄ " (132mm)	9" (229mm)
24" (610mm)	3" (76mm)	Prefix-036F-24	20 ³ / ₄ " (528mm)	15" (381mm)	2 ⁵ / ₈ " (66mm)	13 ¹ / ₂ " (343mm)
	4" (102mm)	Prefix-046F-24	20 ³ / ₄ " (528mm)	16" (406mm)	3 ¹ / ₂ " (88mm)	14" (356mm)
	6" (152mm)	Prefix-066F-24	20 ³ / ₄ " (528mm)	18" (457mm)	5 ¹ / ₄ " (132mm)	15" (381mm)
36" (914mm)	3" (76mm)	Prefix-066F-35	31 ¹ / ₄ " (792mm)	21" (533mm)	2 ⁵ / ₈ " (66mm)	19 ¹ / ₂ " (495mm)
	4" (102mm)	Prefix-046F-36	31 ¹ / ₄ " (792mm)	22" (559mm)	3 ¹ / ₂ " (88mm)	20" (508mm)
	6" (152mm)	Prefix-066F-36	31 ¹ / ₄ " (792mm)	24" (610mm)	5 ¹ / ₄ " (132mm)	21" (553mm)

Prefixes: 22 = Mill-Galv. Steel 23 = Hot-Dip Galv. Steel 24 = Aluminum

45° HORIZONTAL ELBOW

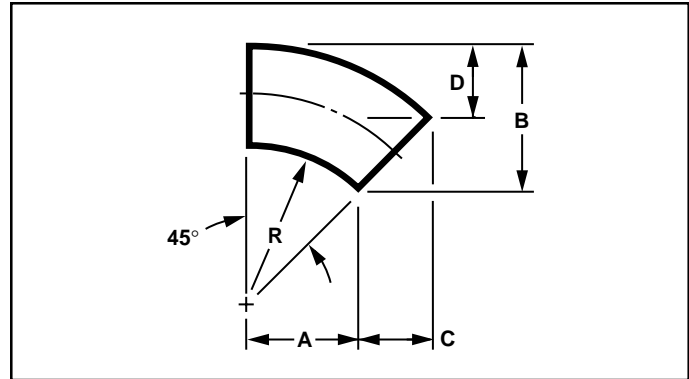

Radius-R	Width - W	Catalog No.	"A" Dim.	"B" Dim.	"C" Dim.	"D" Dim.
12" (305mm)	3" (76mm)	Prefix-034F-12	8½" (216mm)	6½" (165mm)	2⅞" (54mm)	4¾" (112mm)
	4" (102mm)	Prefix-044F-12	8½" (216mm)	7½" (191mm)	2⅞" (71mm)	4¾" (119mm)
	6" (152mm)	Prefix-064F-12	8½" (216mm)	9½" (241mm)	4¼" (108mm)	5¾" (134mm)
24" (610mm)	3" (76mm)	Prefix-034F-24	17⅞" (431mm)	10⅞" (255mm)	2⅞" (54mm)	7⅞" (201mm)
	4" (102mm)	Prefix-044F-24	17⅞" (431mm)	11⅞" (280mm)	2⅞" (71mm)	8¼" (208mm)
	6" (152mm)	Prefix-064F-24	17⅞" (431mm)	13⅞" (331mm)	4¼" (108mm)	8¾" (223mm)
36" (914mm)	3" (76mm)	Prefix-034F-36	25½" (647mm)	13⅞" (344mm)	2⅞" (54mm)	11½" (291mm)
	4" (102mm)	Prefix-044F-36	25½" (647mm)	14⅞" (370mm)	2⅞" (71mm)	11¾" (298mm)
	6" (152mm)	Prefix-064F-36	25½" (647mm)	16⅞" (421mm)	4¼" (108mm)	12¾" (313mm)

Prefixes: 22 = Mill-Galv. Steel 23 = Hot-Dip Galv. Steel 24 = Aluminum

30° HORIZONTAL ELBOW

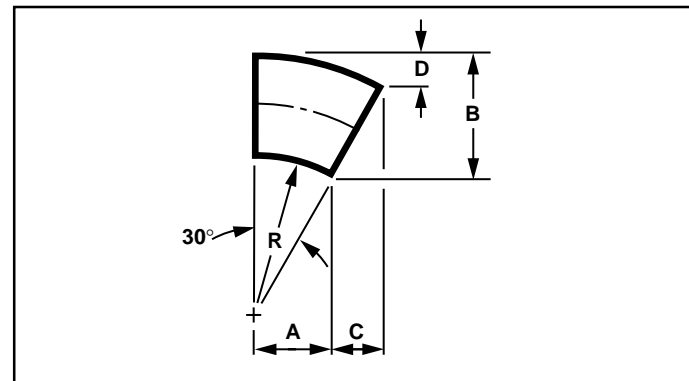

Radius-R	Width - W	Catalog No.	"A" Dim.	"B" Dim.	"C" Dim.	"D" Dim.
12" (305mm)	3" (76mm)	Prefix-033F-12	6" (152mm)	4⅝" (117mm)	1½" (38mm)	2" (51mm)
	4" (102mm)	Prefix-043F-12	6" (152mm)	5⅝" (143mm)	2" (51mm)	2⅞" (55mm)
	6" (152mm)	Prefix-063F-12	6" (152mm)	7⅝" (194mm)	3" (76mm)	2¾" (61mm)
24" (610mm)	3" (76mm)	Prefix-033F-24	12" (305mm)	6¼" (158mm)	1½" (38mm)	3⅝" (92mm)
	4" (102mm)	Prefix-043F-24	12" (305mm)	7¼" (183mm)	2" (51mm)	3¾" (95mm)
	6" (152mm)	Prefix-063F-24	12" (305mm)	9¼" (234mm)	3" (76mm)	4" (102mm)
36" (914mm)	3" (76mm)	Prefix-033F-36	18" (457mm)	7⅞" (198mm)	1½" (38mm)	5¼" (133mm)
	4" (102mm)	Prefix-043F-36	18" (457mm)	8⅞" (224mm)	2" (51mm)	5⅝" (137mm)
	6" (152mm)	Prefix-063F-36	18" (457mm)	10⅞" (275mm)	3" (76mm)	5⅝" (143mm)

Prefixes: 22 = Mill-Galv. Steel 23 = Hot-Dip Galv. Steel 24 = Aluminum



90° VERTICAL INSIDE ELBOW

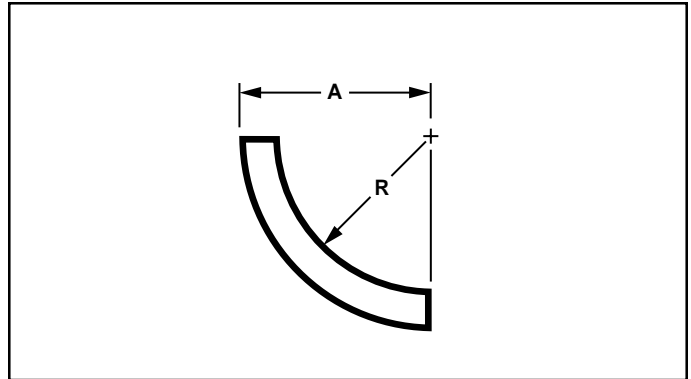
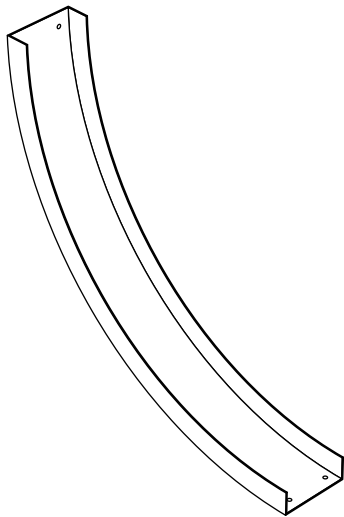

Radius - R	Width - W	Catalog No.	"A" Dimension
12" (305mm)	3" (76mm)	Prefix-0391-12	12" (305mm)
	4" (102mm)	Prefix-0491-12	12" (305mm)
	6" (152mm)	Prefix-0691-12	12" (305mm)
24" (610mm)	3" (76mm)	Prefix-0391-24	24" (610mm)
	4" (102mm)	Prefix-0491-24	24" (610mm)
	6" (152mm)	Prefix-0691-24	24" (610mm)
36" (914mm)	3" (76mm)	Prefix-0391-36	36" (914mm)
	4" (102mm)	Prefix-0491-36	36" (914mm)
	6" (152mm)	Prefix-0691-36	36" (914mm)

Prefixes: 22 = Mill-Galv. Steel 23 = Hot-Dip Galv. Steel 24 = Aluminum

90° VERTICAL OUTSIDE ELBOW

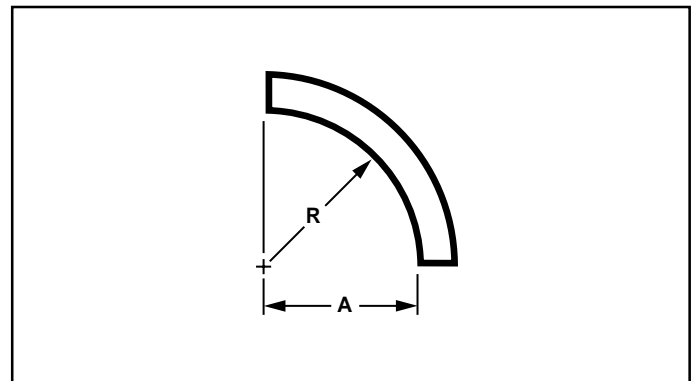
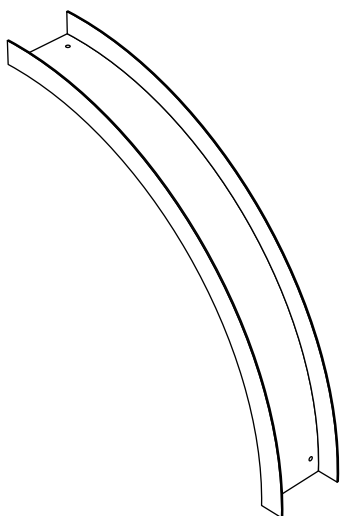

Radius - R	Width - W	Catalog No.	"A" Dimension
12" (305mm)	3" (76mm)	Prefix-0390-12	13 ³ / ₄ " (349mm)
	4" (102mm)	Prefix-0490-12	13 ³ / ₄ " (349mm)
	6" (152mm)	Prefix-0690-12	13 ³ / ₄ " (349mm)
24" (610mm)	3" (76mm)	Prefix-0390-24	25 ³ / ₄ " (654mm)
	4" (102mm)	Prefix-0490-24	25 ³ / ₄ " (654mm)
	6" (152mm)	Prefix-0690-24	25 ³ / ₄ " (654mm)
36" (914mm)	3" (76mm)	Prefix-0390-36	37 ³ / ₄ " (959mm)
	4" (102mm)	Prefix-0490-36	37 ³ / ₄ " (959mm)
	6" (152mm)	Prefix-0690-36	37 ³ / ₄ " (959mm)

Prefixes: 22 = Mill-Galv. Steel 23 = Hot-Dip Galv. Steel 24 = Aluminum



60° VERTICAL INSIDE ELBOW

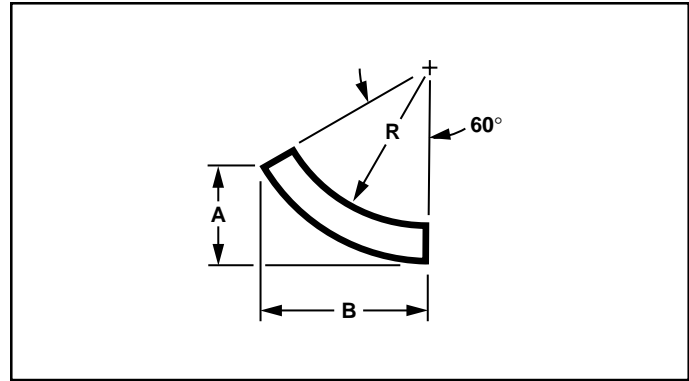
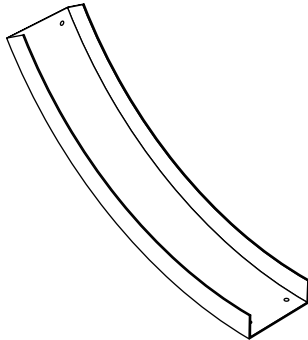

Radius - R	Width - W	Catalog No.	"A" Dim.	"B" Dim.
12" (305mm)	3" (76mm)	Prefix-0361-12	6 ⁷ / ₈ " (175mm)	11 ⁷ / ₈ " (302mm)
	4" (102mm)	Prefix-0461-12	6 ⁷ / ₈ " (175mm)	11 ⁷ / ₈ " (302mm)
	6" (152mm)	Prefix-0641-12	6 ⁷ / ₈ " (175mm)	11 ⁷ / ₈ " (302mm)
24" (610mm)	3" (76mm)	Prefix-0361-24	12 ⁷ / ₈ " (327mm)	22 ¹ / ₄ " (567mm)
	4" (102mm)	Prefix-0461-24	12 ⁷ / ₈ " (327mm)	22 ¹ / ₄ " (567mm)
	6" (152mm)	Prefix-0661-24	12 ⁷ / ₈ " (327mm)	22 ¹ / ₄ " (567mm)
36" (914mm)	3" (76mm)	Prefix-0361-36	18 ⁷ / ₈ " (479mm)	32 ³ / ₄ " (830mm)
	4" (102mm)	Prefix-0461-36	18 ⁷ / ₈ " (479mm)	32 ³ / ₄ " (830mm)
	6" (152mm)	Prefix-0661-36	18 ⁷ / ₈ " (479mm)	32 ³ / ₄ " (830mm)

Prefixes: 22 = Mill-Galv. Steel 23 = Hot-Dip Galv. Steel 24 = Aluminum

60° VERTICAL OUTSIDE ELBOW

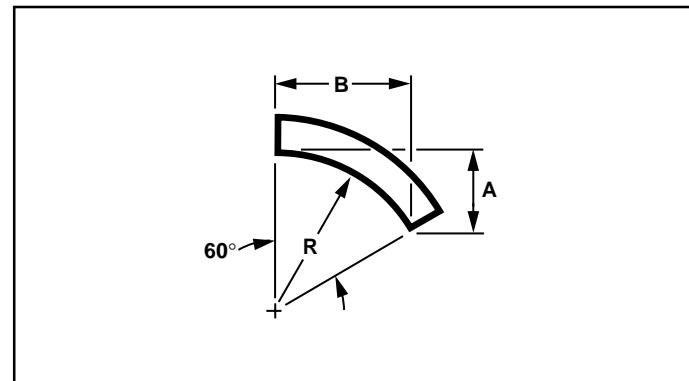
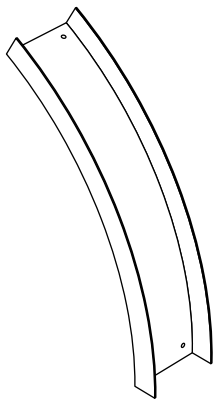

Radius - R	Width - W	Catalog No.	"A" Dim.	"B" Dim.
12" (305mm)	3" (76mm)	Prefix-0360-12	6" (152mm)	10 ³ / ₈ " (264mm)
	4" (102mm)	Prefix-0460-12	6" (152mm)	10 ³ / ₈ " (264mm)
	6" (152mm)	Prefix-0660-12	6" (152mm)	10 ³ / ₈ " (264mm)
24" (610mm)	3" (76mm)	Prefix-0360-24	12" (305mm)	20 ³ / ₄ " (528mm)
	4" (102mm)	Prefix-0460-24	12" (305mm)	20 ³ / ₄ " (528mm)
	6" (152mm)	Prefix-0660-24	12" (305mm)	20 ³ / ₄ " (528mm)
36" (914mm)	3" (76mm)	Prefix-0360-36	18" (457mm)	31 ¹ / ₄ " (792mm)
	4" (102mm)	Prefix-0460-36	18" (457mm)	31 ¹ / ₄ " (792mm)
	6" (152mm)	Prefix-0660-36	18" (457mm)	31 ¹ / ₄ " (792mm)

Prefixes: 22 = Mill-Galv. Steel 23 = Hot-Dip Galv. Steel 24 = Aluminum



45° VERTICAL INSIDE ELBOW

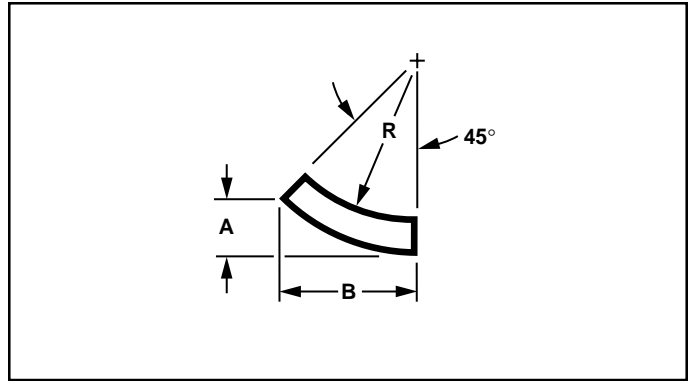
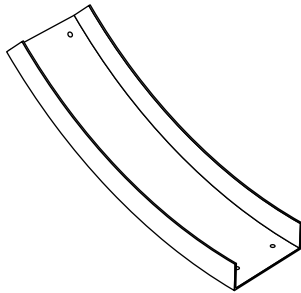

Radius - R	Width - W	Catalog No.	"A" Dim.	"B" Dim.
12" (305mm)	3" (76mm)	Prefix-0341-12	4 1/8" (102mm)	9 3/4" (247mm)
	4" (102mm)	Prefix-0441-12	4 1/8" (102mm)	9 3/4" (247mm)
	6" (152mm)	Prefix-0641-12	4 1/8" (102mm)	9 3/4" (247mm)
24" (610mm)	3" (76mm)	Prefix-0341-24	7 1/2" (191mm)	18 1/4" (463mm)
	4" (102mm)	Prefix-0441-24	7 1/2" (191mm)	18 1/4" (463mm)
	6" (152mm)	Prefix-0641-24	7 1/2" (191mm)	18 1/4" (463mm)
36" (914mm)	3" (76mm)	Prefix-0341-36	11 1/8" (281mm)	26 3/4" (678mm)
	4" (102mm)	Prefix-0441-36	11 1/8" (281mm)	26 3/4" (678mm)
	6" (152mm)	Prefix-0641-36	11 1/8" (281mm)	26 3/4" (678mm)

Prefixes: 22 = Mill-Galv. Steel 23 = Hot-Dip Galv. Steel 24 = Aluminum

45° VERTICAL OUTSIDE ELBOW

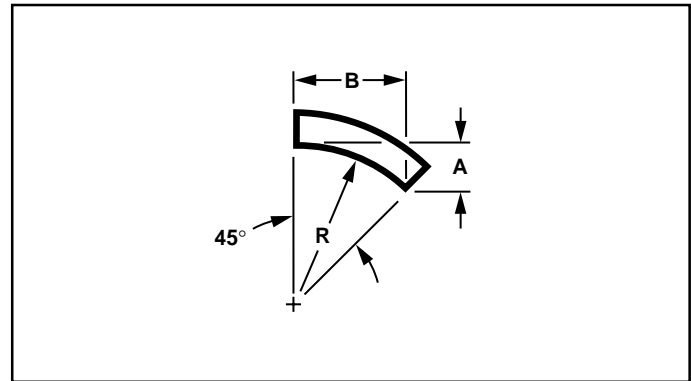
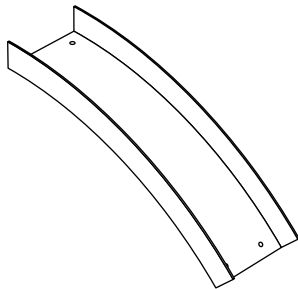

Radius - R	Width - W	Catalog No.	"A" Dim.	"B" Dim.
12" (305mm)	3" (76mm)	Prefix-0340-12	3 1/2" (89mm)	8 1/2" (216mm)
	4" (102mm)	Prefix-0440-12	3 1/2" (89mm)	8 1/2" (216mm)
	6" (152mm)	Prefix-0640-12	3 1/2" (89mm)	8 1/2" (216mm)
24" (610mm)	3" (76mm)	Prefix-0340-24	7 1/8" (179mm)	17 1/8" (431mm)
	4" (102mm)	Prefix-0440-24	7 1/8" (179mm)	17 1/8" (431mm)
	6" (152mm)	Prefix-0640-24	7 1/8" (179mm)	17 1/8" (431mm)
36" (914mm)	3" (76mm)	Prefix-0340-36	10 1/2" (268mm)	25 1/8" (646mm)
	4" (102mm)	Prefix-0440-36	10 1/2" (268mm)	25 1/8" (646mm)
	6" (152mm)	Prefix-0640-36	10 1/2" (268mm)	25 1/8" (646mm)

Prefixes: 22 = Mill-Galv. Steel 23 = Hot-Dip Galv. Steel 24 = Aluminum



30° VERTICAL INSIDE ELBOW

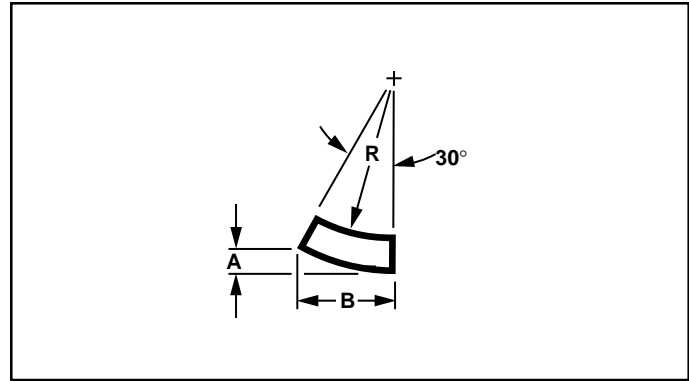
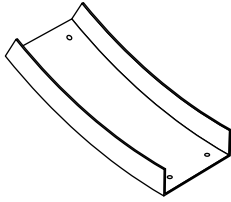

Radius - R	Width - W	Catalog No.	"A" Dim.	"B" Dim.
12" (305mm)	3" (76mm)	Prefix-0331-12	1 7/8" (47mm)	6 7/8" (175mm)
	4" (102mm)	Prefix-0431-12	1 7/8" (47mm)	6 7/8" (175mm)
	6" (152mm)	Prefix-0631-12	1 7/8" (47mm)	6 7/8" (175mm)
24" (610mm)	3" (76mm)	Prefix-0331-24	3 1/2" (87mm)	12 7/8" (327mm)
	4" (102mm)	Prefix-0431-24	3 1/2" (87mm)	12 7/8" (327mm)
	6" (152mm)	Prefix-0631-24	3 1/2" (87mm)	12 7/8" (327mm)
36" (914mm)	3" (76mm)	Prefix-0331-36	5 1/8" (129mm)	18 7/8" (479mm)
	4" (102mm)	Prefix-0431-36	5 1/8" (129mm)	18 7/8" (479mm)
	6" (152mm)	Prefix-0631-36	5 1/8" (129mm)	18 7/8" (479mm)

Prefixes: 22 = Mill-Galv. Steel 23 = Hot-Dip Galv. Steel 24 = Aluminum

30° VERTICAL OUTSIDE ELBOW

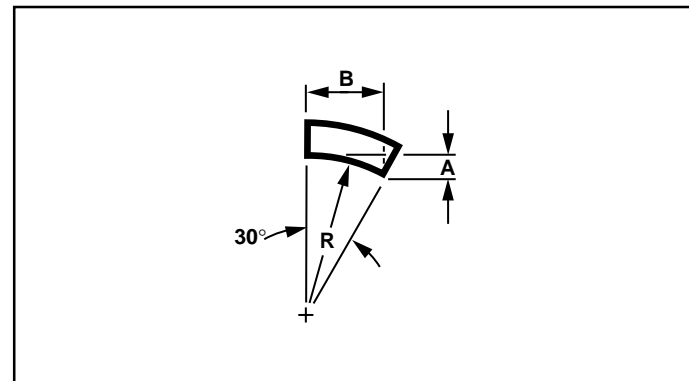
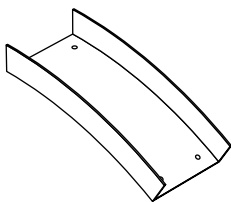

Radius - R	Width - W	Catalog No.	"A" Dim.	"B" Dim.
12" (305mm)	3" (76mm)	Prefix-0330-17	1 5/8" (40mm)	6" (152mm)
	4" (102mm)	Prefix-0430-12	1 5/8" (40mm)	6" (152mm)
	6" (152mm)	Prefix-0630-12	1 5/8" (40mm)	6" (152mm)
24" (610mm)	3" (76mm)	Prefix-0330-24	3 1/4" (82mm)	12" (305mm)
	4" (102mm)	Prefix-0430-24	3 1/4" (82mm)	12" (305mm)
	6" (152mm)	Prefix-0630-24	3 1/4" (82mm)	12" (305mm)
36" (914mm)	3" (76mm)	Prefix-0330-36	4 7/8" (122mm)	18" (457mm)
	4" (102mm)	Prefix-0430-36	4 7/8" (122mm)	18" (457mm)
	6" (152mm)	Prefix-0630-36	4 7/8" (122mm)	18" (457mm)

Prefixes: 22 = Mill-Galv. Steel 23 = Hot-Dip Galv. Steel 24 = Aluminum

HORIZONTAL TEE

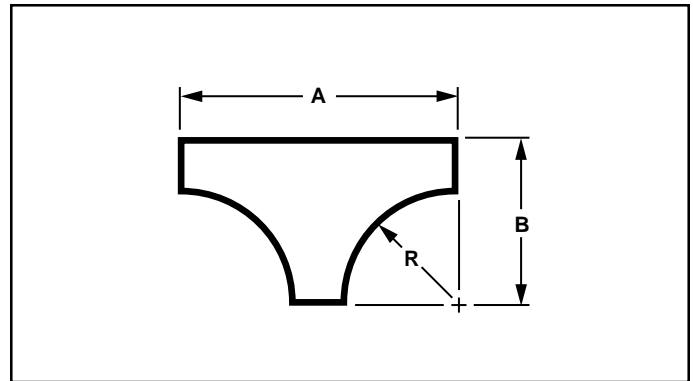
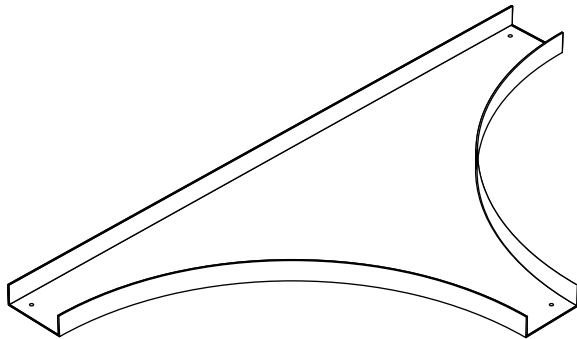

Radius - R	Width - W	Catalog No.	"A" Dim.	"B" Dim.
12" (305mm)	3" (76mm)	Prefix-03FT-12	27" (686mm)	15" (381mm)
	4" (102mm)	Prefix-04FT-12	28" (711mm)	16" (406mm)
	6" (152mm)	Prefix-06FT-12	30" (762mm)	18" (457mm)
24" (610mm)	3" (76mm)	Prefix-03FT-24	51" (1275mm)	27" (686mm)
	4" (102mm)	Prefix-04FT-24	52" (1321mm)	28" (711mm)
	6" (152mm)	Prefix-06FT-24	54" (1372mm)	30" (762mm)
36" (914mm)	3" (76mm)	Prefix-03FT-36	75" (1905mm)	39" (991mm)
	4" (102mm)	Prefix-04FT-36	76" (1930mm)	40" (1016mm)
	6" (152mm)	Prefix-06FT-36	78" (1981mm)	42" (1067mm)

Prefixes: 22 = Mill-Galv. Steel 23 = Hot-Dip Galv. Steel 24 = Aluminum

HORIZONTAL CROSS

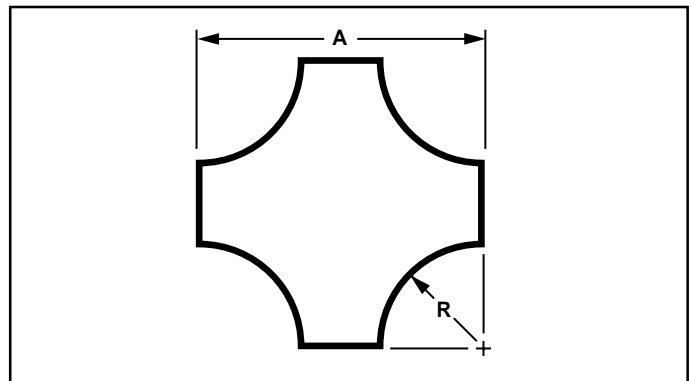
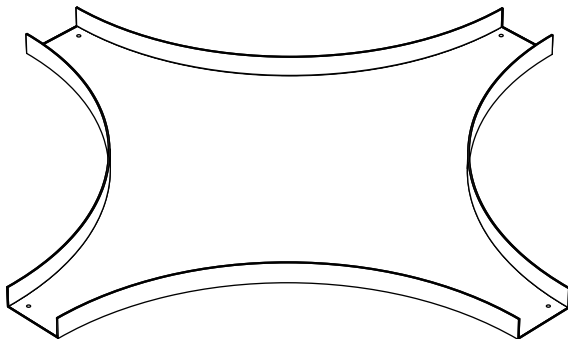

Radius - R	Width - W	Catalog No.	"A" Dim.
12" (305mm)	3" (76mm)	Prefix-03FC-12	27" (686mm)
	4" (102mm)	Prefix-04FC-12	28" (711mm)
	6" (152mm)	Prefix-06FC-12	30" (762mm)
24" (610mm)	3" (76mm)	Prefix-03FC-24	51" (1295mm)
	4" (102mm)	Prefix-04FC-24	52" (1321mm)
	6" (152mm)	Prefix-06FC-24	54" (1372mm)
36" (914mm)	3" (76mm)	Prefix-03FC-36	75" (1905mm)
	4" (102mm)	Prefix-04FC-36	76" (1930mm)
	6" (152mm)	Prefix-06FC-36	78" (1981mm)

Prefixes: 22 = Mill-Galv. Steel 23 = Hot-Dip Galv. Steel 24 = Aluminum

COPE Channel

BLIND END

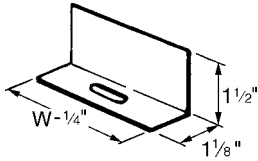

W	Catalog Number
3" (76mm)	Prefix-03BE
4" (102mm)	Prefix-04BE
6" (152mm)	Prefix-06BE

Steel Plated, Furnished with one set 1/4" x 3/4" bolt, nut and washer.

END DROPOUT

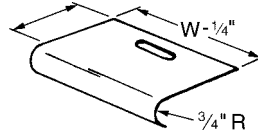

W	Catalog Number
3" (76mm)	Prefix-03DO
4" (102mm)	Prefix-04DO
6" (152mm)	Prefix-06DO

Prefixes: 22 = Mill-Galv. Steel,
23 = Hot-Dip Galv. Steel,
24 = Aluminum
Steel plated, Furnished with one set 1/4" x 3/4" bolt, nut and washer.

CHANNEL HOLDDOWN CLAMP (STAINLESS STEEL)

Part No. 9079

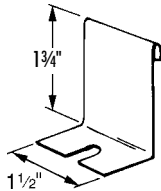

For use with steel or aluminum systems.
(No hardware included.)

NYLON DROPOUT GROMMET - PART NO. DOG-1

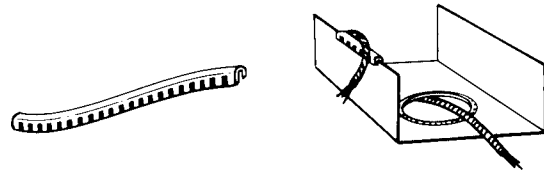

Use at cable dropouts, over sides or thru vent holes.
Furnished in 12' lengths. Cut to length in field.

STANDARD CONNECTOR

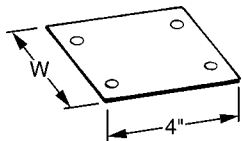

W	Catalog Number
3" (76mm)	Prefix-03CS
4" (102mm)	Prefix-04CS
6" (152mm)	Prefix-06CS

Prefixes: 22 = Mill-Galv. Steel,
23 = Hot-Dip Galv. Steel,
24 = Aluminum
Hardware: 3/8" x 3/4" Bolt and flanged nut
Steel plated incl. (4-sets)

CHANNEL TO BOX OR WALL CONNECTOR

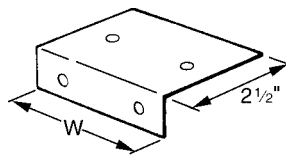

W	Catalog Number
3" (76mm)	Prefix-03CB
4" (102mm)	Prefix-04CB
6" (152mm)	Prefix-06CB

Prefixes: 22 = Mill-Galv. Steel,
23 = Hot-Dip Galv. Steel,
24 = Aluminum
Furnished with two sets 3/8" x 3/4" bolt,
nut and washer
Steel plated.

ADJUSTABLE HORIZONTAL CONNECTOR

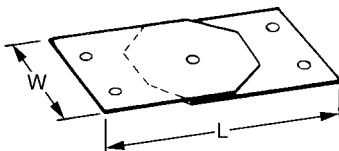

W	L	Catalog No.
3" (76mm)	7 1/2" (191mm)	Prefix-03CH
4" (102mm)	8 1/2" (216mm)	Prefix-04CH
6" (152mm)	10 1/2" (267mm)	Prefix-06CH

Prefixes: 22 = Mill-Galv. Steel,
23 = Hot-Dip Galv. Steel,
24 = Aluminum
Hardware: 3/8" x 3/4" Bolt and
flanged nut
Steel plated incl. (4-sets)

EXPANSION CONNECTOR

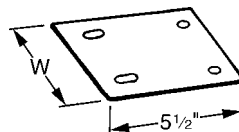

W	Catalog Number
3" (76mm)	Prefix-03CE
4" (102mm)	Prefix-04CE
6" (152mm)	Prefix-06CE

Prefixes: 22 = Mill-Galv. Steel,
23 = Hot-Dip Galv. Steel,
24 = Aluminum
Hardware: 3/8" x 3/4" Bolt and flanged nut
Steel plated incl. (4-sets)

ADJUSTABLE RISER CONNECTOR

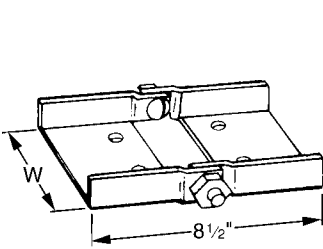

W	Catalog Number
3" (76mm)	Prefix-03CV
4" (102mm)	Prefix-04CV
6" (152mm)	Prefix-06CV

Prefixes: 22 = Mill-Galv. Steel,
 23 = Hot-Dip Galv. Steel,
 24 = Aluminum
 Hardware: 3/8" x 3/4" Bolt and flanged nut
 Steel plated incl. (4-sets)

COVER CONNECTOR

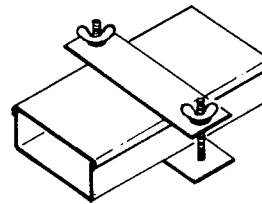

W	Catalog Number
3" (76mm)	Prefix-03CC
4" (102mm)	Prefix-04CC
6" (152mm)	Prefix-06CC

Prefixes: 22 = Mill-Galv. Steel,
 23 = Hot-Dip Galv. Steel,
 24 = Aluminum
 Hardware: 1/4" x 2 1/4" Machine screw
 and wing nut
 Steel plated incl. (2-sets)

INTERCONNECTIONS

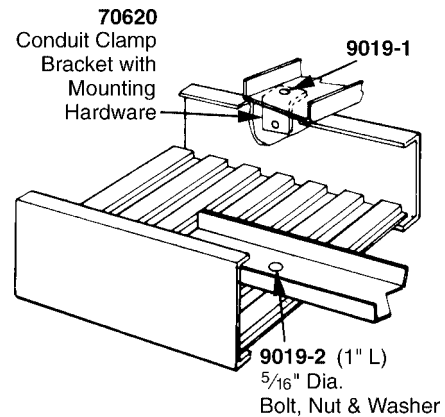
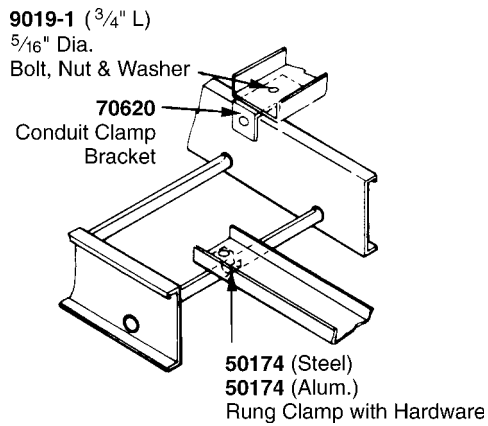

CHANNEL HANGERS

For 3"-, 4"- or 6"- wide Cope Channel raceways. Pipe sleeve accommodates either 3/8" or 1/2" diameter rods. Finish is hot-dip galvanized after fabrication. Order hardware separately.

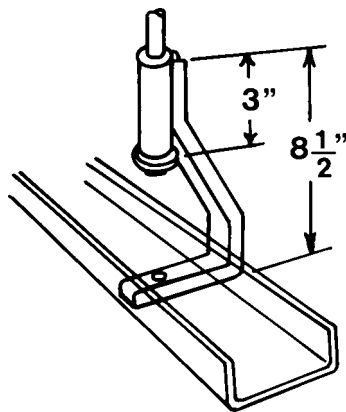

SINGLE CHANNEL HANGER

Catalog No.	Use With
9013	3"- & 4"-wide channel
9013-1	6"-wide channel

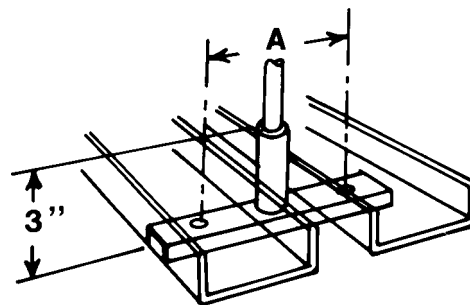

DOUBLE CHANNEL HANGER

Catalog No.	Use With	Dimension "A"
9014	3"- & 4"-wide channel	5"
9014-1	6"-wide channel	7"

ENGLISH TO METRIC CONVERSION			METRIC TO ENGLISH CONVERSION		
To Convert From	To	Multiply By	To Convert From	To	Multiply By
Length					
Inch [in]	Millimeter [mm]	25.400 000	Millimeter [mm]	Inch [in]	0.039 370
Foot [ft]	Meter [m]	0.304 800	Meter [m]	Foot [ft]	3.280 840
Yard [yd]	Meter [m]	0.914 400	Meter [m]	Yard [yd]	1.093 613
Mile (U.S. Statute) [mi]	Kilometer [km]	1.609 347	Kilometer [km]	Mile (U.S. Statute) [mi]	0.621 370
Area					
Square Inch [in ²]	Square Millimeter [mm ²]	645.16	Square Millimeter [mm ²]	Square Inch [in ²]	0.001550
Square Foot [ft ²]	Square Meter [m ²]	0.092 903	Square Meter [m ²]	Square Foot [ft ²]	10.763 915
Square Yard [yd ²]	Square Meter [m ²]	0.836 127	Square Meter [m ²]	Square Yard [yd ²]	1.195 991
Square Mile [mi ²] (U.S. Statute)	Square Kilometer [km ²]	2.589 998	Square Kilometer [km ²]	Square Mile [mi ²] (U.S. Statute)	0.386 101
Acre	Square Meter [m ²]	4046.873	Square Meter [m ²]	Acre	0.000 247
Acre	Hectare	0.404 687	Hectare	Acre	2.471 046
Volume					
Cubic Inch [in ³]	Cubic Millimeter [mm ³]	16387.06	Cubic Millimeter [mm ³]	Cubic Inch [in ³]	0.000061
Cubic Foot [ft ³]	Cubic Meter [m ³]	0.028 317	Cubic Meter [m ³]	Cubic Foot [ft ³]	35.314 662
Cubic Yard [yd ³]	Cubic Meter [m ³]	0.764 555	Cubic Meter [m ³]	Cubic Yard [yd ³]	1.307 950
Gallon (U.S. Liquid) [gal]	Litre [l]	3.785 412	Litre [l]	Gallon (U.S. Liquid) [gal]	0.264 172
Quart (U.S. Liquid) [qt]	Litre [l]	0.946 353	Litre [l]	Quart (U.S. Liquid) [qt]	1.056 688
Mass					
Ounce (Avoirdupois) [oz]	Gram [g]	28.349 520	Gram [g]	Ounce (Avoirdupois) [oz]	0.035 274
Pound (Avoirdupois) [lb]	Kilogram [kg]	0.453 592	Kilogram [kg]	Pound (Avoirdupois) [lb]	2.204 624
Short Ton	Kilogram [kg]	907.185	Kilogram [kg]	Short Ton	0.00110
Force					
Ounce-Force	Newton [N]	0.278 014	Newton [N]	Ounce-Force	3.596 941
Pound-Force [lbf]	Newton [N]	4.448 222	Newton [N]	Pound-Force [lbf]	0.224 809
Bending Moment					
Pound-Force-Inch [lbf-in]	Newton-Meter [N-m]	0.112 985	Newton-Meter [N-m]	Pound-Force-Inch [lbf-in]	8.850 732
Pound-Force-Foot [lbf-ft]	Newton-Meter [N-m]	1.355 818	Newton-Meter [N-m]	Pound-Force-Foot [lbf-ft]	0.737 562
Pressure, Stress					
Pound-Force per Square Inch [lbf/in ²]	Kilopascal [kPa]	6.894 757	Kilopascal [kPa]	Pound-Force per Square Inch [lbf/in ²]	0.145 038
Foot of Water (39.2 F)	Kilopascal [kPa]	2.988 980	Kilopascal [kPa]	Foot of Water (39.2 F)	0.334 562
Inch of Mercury (32 F)	Kilopascal [kPa]	3.386 380	Kilopascal [kPa]	Inch of Mercury (32 F)	0.295 301
Energy, Work, Heat					
Foot-Pound-Force [ft-lbf]	Joule [J]	1.355 818	Joule [J]	Foot-Pound-Force [ft-lbf]	0.737 562
British Thermal Unit [Btu]	Joule [J]	1055.056	Joule [J]	British Thermal Unit [Btu]	0.000948
Calorie [cal]	Joule [J]	4.186 800	Joule [J]	Calorie [cal]	0.238 846
Kilowatt Hour [kW-h]	Joule [J]	3600000	Joule [J]	Kilowatt Hour [kW-h]	2.78 ⁻⁷
Power					
Foot-Pound-Force /Second [ft-lbs/s]	Watt [W]	1.355 818	Watt [W]	Foot-Pound-Force /Second [ft-lbs/s]	0.737 562
British Thermal Unit /Hour [Btu/h]	Watt [W]	0.293 071	Watt [W]	British Thermal Unit /Hour [Btu/h]	3.412 142
Horsepower (550 Ft. Lbf/s) [hp]	Kilowatt [kW]	0.745 700	Kilowatt [kW]	Horsepower (550 Ft. Lbf/s) [hp]	1.341 022
Angle					
Degree	Radian [rad]	0.017 453	Radian [rad]	Degree	57.295 788
Temperature					
Degree Fahrenheit [F]	Degree Celsius [C]	(F° -32)/1.8	Degree Celsius [C]	Degree Fahrenheit [F]	1.8xC°+32

	$1/64$	0.015625		$33/64$	0.515625	
	$1/32$	0.03125		$17/32$	0.53125	
		$3/64$	0.046875		$35/64$	0.546875
$1/16$			0.0625	$9/16$	0.5625	
		$5/64$	0.078125		$37/64$	0.578125
	$3/32$		0.09375		$19/32$	0.59375
		$7/64$	0.109375		$39/64$	0.609375
$1/8$			0.125	$5/8$	0.625	
		$9/64$	0.140625		$41/64$	0.640625
	$5/32$		0.15625		$21/32$	0.65625
		$11/64$	0.171875		$43/64$	0.671875
$3/16$			0.1875	$11/16$	0.6875	
		$13/64$	0.203125		$45/64$	0.703125
	$7/32$		0.21875		$23/32$	0.71875
		$15/64$	0.234375		$47/64$	0.734375
$1/4$			0.25	$3/4$	0.75	
		$17/64$	0.265625		$49/64$	0.765625
	$9/32$		0.28125		$25/32$	0.78125
		$19/64$	0.296875		$51/64$	0.796875
$5/16$			0.3125	$13/16$	0.8125	
		$21/64$	0.328125		$53/64$	0.828125
	$11/32$		0.34375		$27/32$	0.84375
		$23/64$	0.359375		$55/64$	0.859375
$3/8$			0.375	$7/8$	0.875	
		$25/64$	0.390625		$57/64$	0.890625
	$13/32$		0.40625		$29/32$	0.90625
		$27/64$	0.421875		$59/64$	0.921875
$7/16$			0.4375	$15/16$	0.9375	
		$29/64$	0.453125		$61/64$	0.953125
	$15/32$		0.46875		$31/32$	0.96875
		$31/64$	0.484375		$63/64$	0.984375
$1/2$			0.5	1	1.	

COPE QUOTATION CHECK LIST



T.J. Cope, Inc.

11500 Norcom Road • Philadelphia, PA 19154
Phone: 800-688-4857 • Fax: 215-961-2580

PROJECT NAME: _____

DATE: _____

LOCATION: _____

TRAY TYPE

- | | | | |
|--------------------------|------------------------|--------------------------|-----|
| <input type="checkbox"/> | Cope Ladder* | *RUNG SPACING | |
| <input type="checkbox"/> | Cope Hat* | <input type="checkbox"/> | 6" |
| <input type="checkbox"/> | Cope Ventilated Trough | <input type="checkbox"/> | 9" |
| <input type="checkbox"/> | Cope Solid Trough | <input type="checkbox"/> | 12" |
| <input type="checkbox"/> | Cope Channel | <input type="checkbox"/> | 18" |
| <input type="checkbox"/> | Cope Centipede* | | |
| <input type="checkbox"/> | Cope CatTray | | |

TRAY MATERIAL

- Aluminum
- Steel, Pre-Galvanized
- Steel, HDGAF
- 304 Stainless Steel
- 316 Stainless Steel
- Fiberglass
- Other

STRUCTURAL REQUIREMENTS

- NEMA CLASS**
- | | | | | | | | |
|--------------------------|----|--------------------------|-----|--------------------------|-----|--------------------------|-----|
| <input type="checkbox"/> | 8A | <input type="checkbox"/> | 12A | <input type="checkbox"/> | 16A | <input type="checkbox"/> | 20A |
| <input type="checkbox"/> | 8B | <input type="checkbox"/> | 12B | <input type="checkbox"/> | 16B | <input type="checkbox"/> | 20B |
| <input type="checkbox"/> | 8C | <input type="checkbox"/> | 12C | <input type="checkbox"/> | 16C | <input type="checkbox"/> | 20C |
- OR
- Cable Weight _____
- Support Span _____

LOAD DEPTH

- 3"
- 4"
- 5"
- 6"

FITTING RADIUS

- 12"
- 24"
- 36"

SPECIAL REQUIREMENTS

DELIVERY REQUIREMENTS
